

# ZUCO

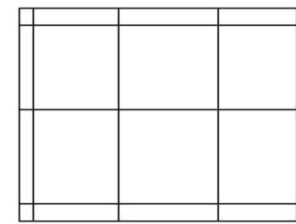

**Model Name**  
Zuco King Headboard

**Dimensions**  
78"W x 1 1/2"D x 42"H

**Color/Finish**  
Dark Mocha with PU

**Notes**

- Solid wood frame
- Wood cleat for flush wall mounting

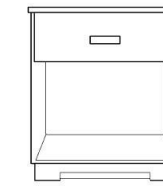

**Model Name**  
Zuco Nightstand

**Dimensions**  
22"W x 16"D x 28"H

**Color/Finish**  
Dark Mocha with Accents of White

**Notes**

- Single-drawer
- Solid wood edges
- High Pressure Laminate Top

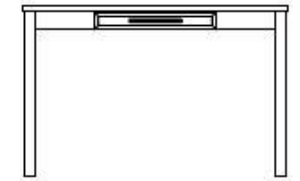

**Model Name**  
Zuco Writing Desk

**Dimensions**  
48"W x 26"D x 30"H

**Color/Finish**  
Dark Mocha with Accents of White

**Notes**

- Single-drawer
- Solid wood edges
- High Pressure Laminate Top

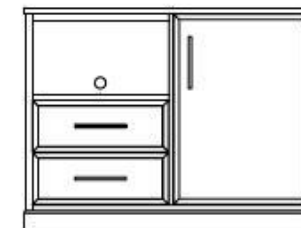

**Model Name**  
Zuco Microfridge Unit

**Dimensions**  
54"W x 22"D x 44"H

**Color/Finish**  
Dark Mocha with Accents of White

**Notes**

- 2-drawers
- Solid wood edges
- Fridge and Microwave housing
- Single door

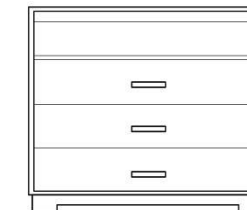

**Model Name**  
Zuco Media Chest

**Dimensions**  
42"W x 26"D x 36"H

**Color/Finish**  
Dark Mocha with Accents of White

**Notes**

- 3-drawers
- Solid wood edges
- High Pressure Laminate Top

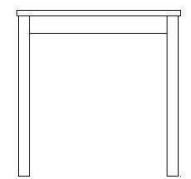

**Model Name**  
Zuco Custom Activity Table

**Dimensions**  
30"W x 30"D x 30" H

**Color/Finish**  
Dark Mocha

**Notes**

- Single-drawer
- Solid wood edges
- High Pressure Laminate Top



**Model Name**  
Zuco Custom Cocktail Table

**Dimensions**  
34"W x 20"D x 18"H

**Color/Finish**  
Dark Mocha

**Notes**

- Solid wood edges
- High Pressure Laminate Top

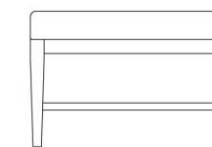

**Model Name**  
Zuco Custom Luggage Bench

**Dimensions**  
30"W x 18"D x 17"H

**Color/Finish**  
Dark Mocha (With Fabric)

**Notes**

- Solid wood edges and legs
- Upholstered seat
- Optional High pressure laminate top

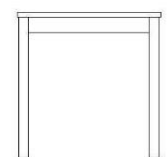

**Model Name**  
Zuco Corner Table

**Dimensions**  
26"W x 26"D x 18"H

**Color/Finish**  
Dark Mocha

**Notes**

- Solid wood edges
- High Pressure Laminate Top



**REDEFINING QUALITY  
AT AFFORDABLE PRICES**

MY HOSPITALITY SUPPLIES  
CONTRACT FURNITURE

### Features & Benefits

- Solid wood edges, legs, panels, and trim.
- Made with hardwood solids and veneers
- Scratch and stain resistant high pressure laminate tops
- Smooth gliding Full extension drawers with guides

**MHS** MY HOSPITALITY SUPPLIES  
CONTRACT FURNITURE

5201 Brokhollow Parkway, Norcross, GA 30071  
1-864-659-0017 | www.myhospitalitysupplies.com

5201 Brokhollow Parkway, Norcross, GA 30071 | 1-864-659-0017 | www.myhospitalitysupplies.com

# THE ZUCO COLLECTION



The Zuco collection is one of our most simplest designs, but yet still gives off an elegant feel because of its contemporary design. With a high-pressure laminate top for scratch resistance, this collection is very low-maintenance without the compromise of style and quality.



MY HOSPITALITY SUPPLIES  
CONTRACT FURNITURE